

Sensors

The sensors can be selected to suit the required measurement range, sensor size, and sensor shape.

Type	VE-121	VE-222	VE-521	VE-133	VE-231	VE-531
Gap rating	0 to 0.1mm	0 to 0.2mm	0 to 0.5mm	0 to 1.0mm	0 to 2.0mm	0 to 5.0mm
Resolution	0.1 μ m	0.1 μ m	0.1 μ m	0.1 μ m	1 μ m	1 μ m
Linearity *1	-0.15% of full scale					
Minimum target diameter	ϕ 3	ϕ 6	ϕ 8	ϕ 10	ϕ 20	ϕ 40
Cable length *2	Directly connected 2.5 m cable			VL-331(3m), VL-332(5m), VL-333(10m) Cable separately sold		
Operating temperature range	0~+80°C					
Temperature coefficient *3	$K_1=1.7 \times 10^{-5}$, $K_2=3.4 \times 10^{-5}$					
Dimensions	ϕ 3 \times 17mm	ϕ 6 \times 10mm	ϕ 8 \times 17mm	ϕ 10 \times 21mm	ϕ 20 \times 30mm	ϕ 40 \times 30mm
Weight	73g (Cable included)	73g (Cable included)	78g (Cable included)	7.1g	60g	123g

VE Series (sensors)

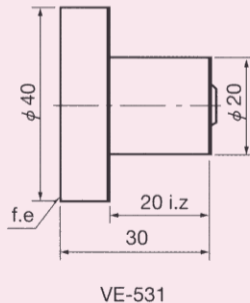
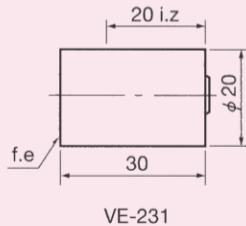
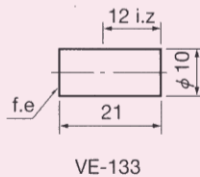
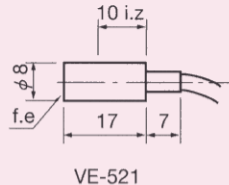
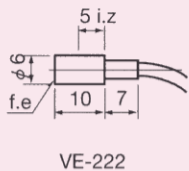
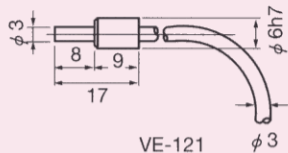

VL Series (sensor cables for VE-133, 231, 531)

