

VW-3100

Portable Vibration Meter

Quick Start Guide

This document is a quick start guide that describes precautions and preparations for handling VW-3100 Portable Vibration Meter, basic operation methods, etc.

- Be sure to read this guide before using this product.
- Use this product by following the instructions described in this guide.
- The precautions specific to this product may be noted on the main unit or in other instruction manuals accompanying it. These precautions must also be observed when you use the product.
- For details and specifications of the functions and operations of this product, refer to the instruction manual. You can download the instruction manual from the download site after performing user registration.

Request for user registration

We recommend you to register as a user. With user registration performed, you are notified of the version upgrade information, defect information, and technical information on support for the registered product. To register as a user, access the user registration site. https://www.onosokki.co.jp/English/hp_e/c_support/registration/newregistration.htm Alternatively, you can access our user registration site directly by reading the following QR code.

- QR code is a registered trademark of DENSO WAVE INCORPORATED.



ONOSOKKI

<https://www.onosokki.co.jp/English/english.htm>

WORLDWIDE

ONOSOKKI CO., LTD.
12th Floor, Yokohama Connect Square Bldg., 3-3-3 Minatomirai, Nishi-ku, Yokohama 220-0012, JAPAN
Phone: +81-45-514-2603/Fax: +81-45-935-3808 (Overseas sales section)
E-mail: overseas@onosokki.co.jp
* Outer appearance and specifications are subject to change without prior notice.
Copyright © ONO SOKKI CO., LTD. 2025 All rights reserved.

900001131/IM25070702 (1.2) 4-2*2

For Your Safety

Safety indications

Meaning of notations

This manual uses the following symbols for safe use of the product. These notations indicate the severity of effects if the instructions are not followed.

	WARNING	Indicates a hazardous situation that, if not avoided, will result in death or serious injury.
	CAUTION	Indicates a hazardous situation that, if not avoided, may result in minor injury or property damage.
	NOTICE	Indicates a hazardous situation that, if not avoided, may result in property damage including failure of the equipment, system, or facility, but will not result in personal injury.

Meaning of symbols

Symbol	Meaning
	Indicates that failure to observe the instructions may cause hazardous situation. The pictogram in the symbol indicates the type of hazard involved.
	Indicates a prohibited action. The pictogram in or beside the symbol specifically indicates a prohibited action.
	Indicates a mandatory action. The pictogram in the symbol specifically indicates a mandatory action that must be carried out. This action is necessary to avoid hazards.

Precautions for use

CAUTION

- Never uncover or disassemble the instrument.
- Using the instrument in the uncovered or disassembled state may cause trouble, such as failure. For internal adjustment, inspection or repair, contact your nearest Ono Sokki sales office or the distributor where you purchased the instrument.

Precautions for using signal input/output connectors

CAUTION

- Do not apply an input voltage exceeding the rating to the signal input connector and EXT IN connector.
- Applying an input voltage exceeding the rating may cause failure or damage.

Do not input an external signal to the AC/THR, DC, and PHONE connectors.

- Inputting an external signal to the output connector may cause failure or damage.

Notes on water-proof performance

CAUTION

- Avoid using this product in a location exposed to dropping or splash of water without taking a water-proof measure.
- The water-proof performance of this product is effective only when all the following conditions are met.
 - A sensor is connected properly to the signal input connector.
 - Dedicated caps are attached surely to the PHONE and EXT IN connectors.
 - The bottom cover is closed securely without leaving a gap.
 - The battery cover on the rear panel is closed securely and locked.

If water gets inside the instrument, stop using it immediately and contact your nearest Ono Sokki sales office or the distributor where you purchased the instrument as soon as possible.

- Do not use this product with deteriorated water-proof packing or cap.
- The water-proof packing and cap may deteriorate depending on the operation environment, resulting in impaired water-proof performance. For a request for replacement, contact your nearest Ono Sokki sales office or the distributor where you purchased the instrument.

Although a water-proof measure has been taken, immediately wipe off water when this product gets wet.

- If water gets inside the instrument, it may cause failure due to short-circuit or heat generation.

Precautions for carrying this product

CAUTION

- When carrying this product, do not hit or rub the protruded parts of the main unit, such as signal input connector, with a hard object.
- Giving a shock to the connector or other parts of this product may damage the product.

Before touching the connector of this product directly, we recommend that you ground your body.

- Static electricity may cause the internal devices to fail or be damaged.

Precautions for battery

CAUTION

- Do not throw a battery into fire. Also, do not heat or disassemble a battery.
- It may cause leakage, heat generation, or burst of the battery.

Insert a battery observing the correct direction of the polarity (+/-).

- If a battery is inserted incorrectly, it may cause abnormal reaction in charging or short-circuit. It may also pose a risk of leakage, heat generation, or burst.

Do not use batteries combining a new battery with a used or old battery, or mixing batteries of different brands or types.

- It may cause leakage, heat generation, or burst due to difference in battery characteristics.

Remove an exhausted battery immediately.

- Leaving the product with an exhausted battery inserted for a long time may cause leakage, heat generation, or burst, resulting in damage to the product.

If the alkaline liquid leaked from an alkaline battery enters your eye, there is a risk of disorder such as sight loss.

- In this case, do not rub the eye, and rinse with plenty of clean water such as tap water immediately and then receive medical attention by a doctor.

If the liquid leaked from a battery attaches to your skin or clothing, rinse it with clean water such as tap water immediately.

If this product is not used for a long time, remove batteries from it.

- If the product is not used for a long time with batteries inserted, the gas generated from the batteries may cause leakage, resulting in damage to the product.

Do not use, store, or leave batteries in a location exposed to strong direct sunlight or in a hot place such as inside of a car under the blazing sun.

- It may cause leakage, heat generation, or burst of the battery. It may also result in impaired battery performance or shortened service life.

When storing or disposing of a battery, insulate the terminal part with tape or the like.

- Making a contact with another battery or metallic object may cause leakage, heat generation, or burst.

Use batteries that do not pass the recommended use-by date.

- If you use a battery that has passed the recommended use-by date, expected battery performance may not be obtained. Furthermore, leakage of the battery may occur.

When disposing of batteries, do it appropriately in accordance with the instructions of the local government.

Precautions for lithium coin secondary battery

WARNING

- Do not throw the lithium coin secondary battery into fire. Also, do not heat or disassemble the battery.
- It may cause leakage, heat generation, burst, or fire.

When replacing the lithium coin secondary battery, be sure to contact your nearest Ono Sokki sales office or the distributor where you purchased the instrument.

When disposing of the lithium coin secondary battery, do it appropriately in accordance with the instructions of the local government.

Precautions for disposal

NOTICE

- Dispose of this product and the provided optional parts in accordance with the local disposal rules.
- For details about disposal, contact the local government.

Precautions for electromagnetic environment

NOTICE

- This product is intended to be used in an industrial electromagnetic environment.
- Using the product in a home environment may cause electromagnetic interference. In this case, the user may be required to take an appropriate measure.

Precautions for storage

CAUTION

- This product is a precision electronic device. Do not leave the product in a hot or cold place.

Precautions for maintenance

CAUTION

- Always keep the instrument clean.
- Especially, dusty or oil-contaminated connectors may cause malfunction. When cleaning the panel surface, do not use volatile materials such as thinner.

Checking Supplied Items

When unpacking the product, check that all the supplied items are included and that the unit has no visible damage.

- The supplied items listed below are delivered with the system having standard specifications. Optional items are not included. When you purchased an optional item, check that it is included.

Item	Quantity	Remarks
Signal cable (AX-501)	1	Used for analog output
SD card	1	
BNC cap	1	Attached to the main unit
Quick Start Guide	1 set	This manual

List of Optional Functions and Items

Model	Function/item name
VW-0310	Equalizing Function
VW-0320	Recording and Comparison Function
VW-0330	Filter Expansion Function
VW-0340	ISO Evaluation and Judgment Function
VW-0350	Assist Tool Communication Function
VW-0360	Vibration Diagnosis Assist Tool
VW-0010	Accessories for VW-3100
CC-0024	Soft carrying case for VW-3100

Preparation: Inserting Batteries

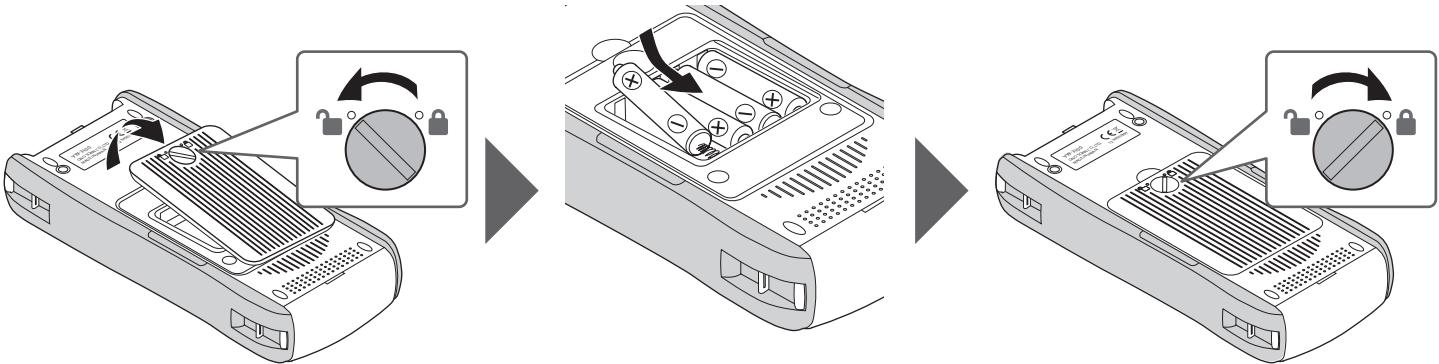

- Be sure to turn off the instrument before inserting batteries. Remove a USB cable if it is used to connect with a personal computer, AC adapter, or mobile battery.
- In order to display correct battery level, select the type of the batteries inserted with [Battery Type] in [General Condition].

Connection

Be sure to turn off the power before connecting a sensor or peripheral device to the instrument.

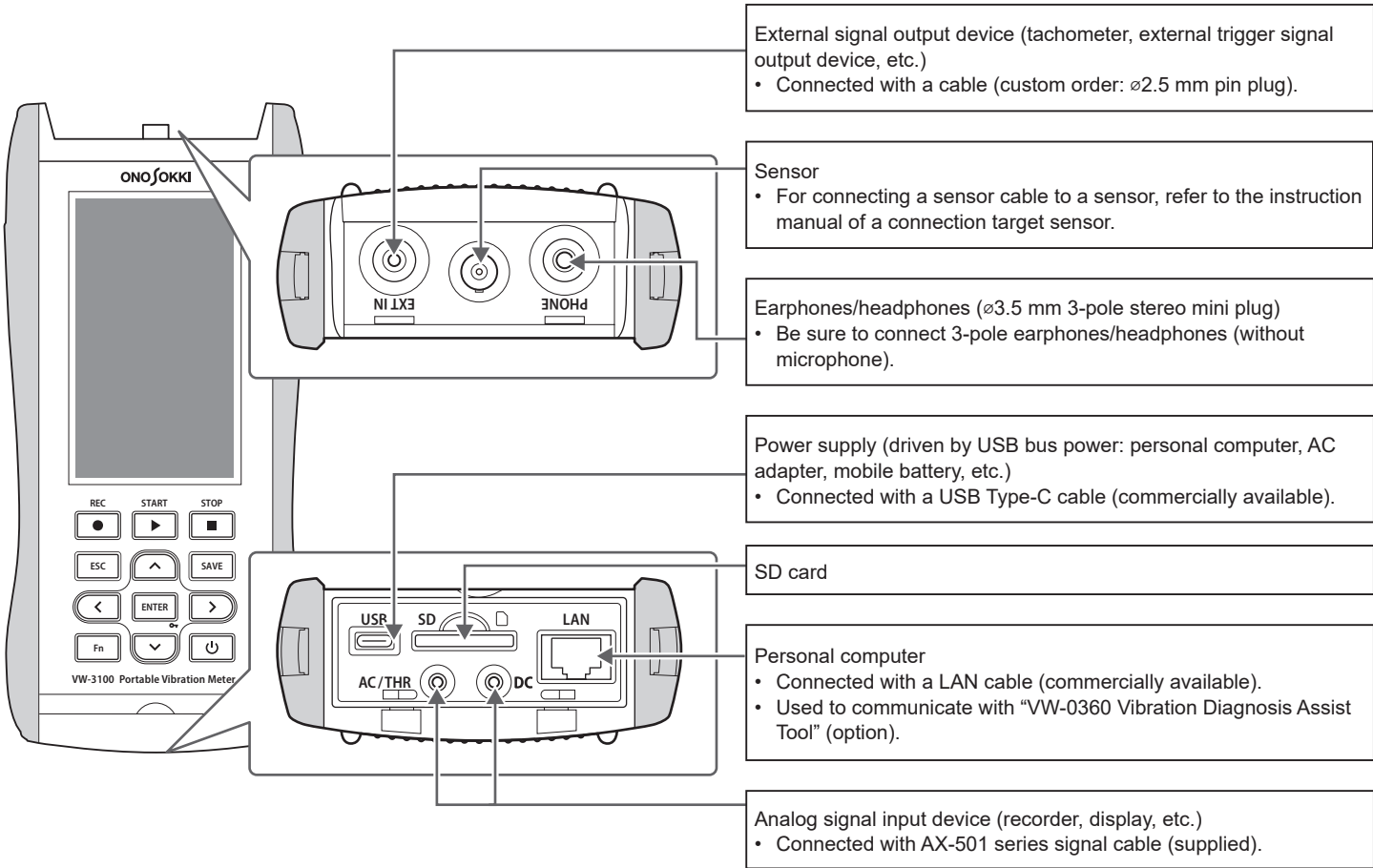

Basic Operations via Main Unit

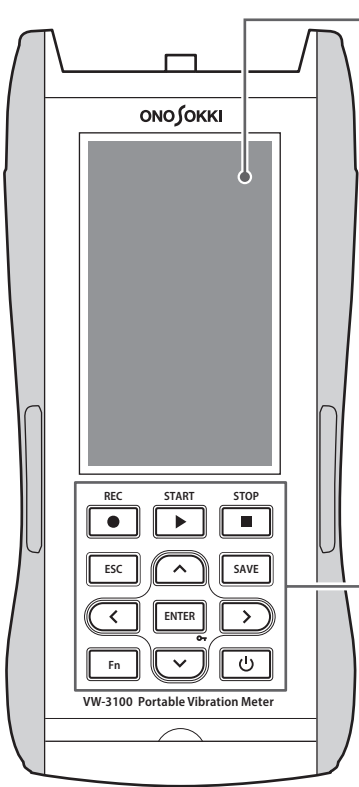

LCD: Switching screens, changing settings, etc. are available via the touch panel.

Operation buttons

REC button	Enters a recording standby state. Pressing the START button starts recording simultaneously with measurement.
ESC button	Cancels a setting or input value, and displays the screen 1 layer above the current screen. If there is no layer, the measurement screen will be displayed. Pressing this button during live measurement (instant display) resets the maximum value (HLD).
$\wedge / \vee / \lt / \gt$ button	Used to select a setting item, move the digit in inputting a value, or change a value.
ENTER/ (screen protection) button	Confirms settings or input value. Holding down this button (approximately 1 second) enables/disables screen protection.
Fn (function) button	Returns to the [HOME] screen when this button is pressed with the setting screen displayed or in the assist tool communication mode. Pressing this button with the data save dialog displayed displays the [File Name] screen.
START button	Starts measurement.
STOP button	Stops measurement.
SAVE button	Saves measured/recorded data.
(standby) button	Turns on/off the power.

Basic Operations of Touch Panel

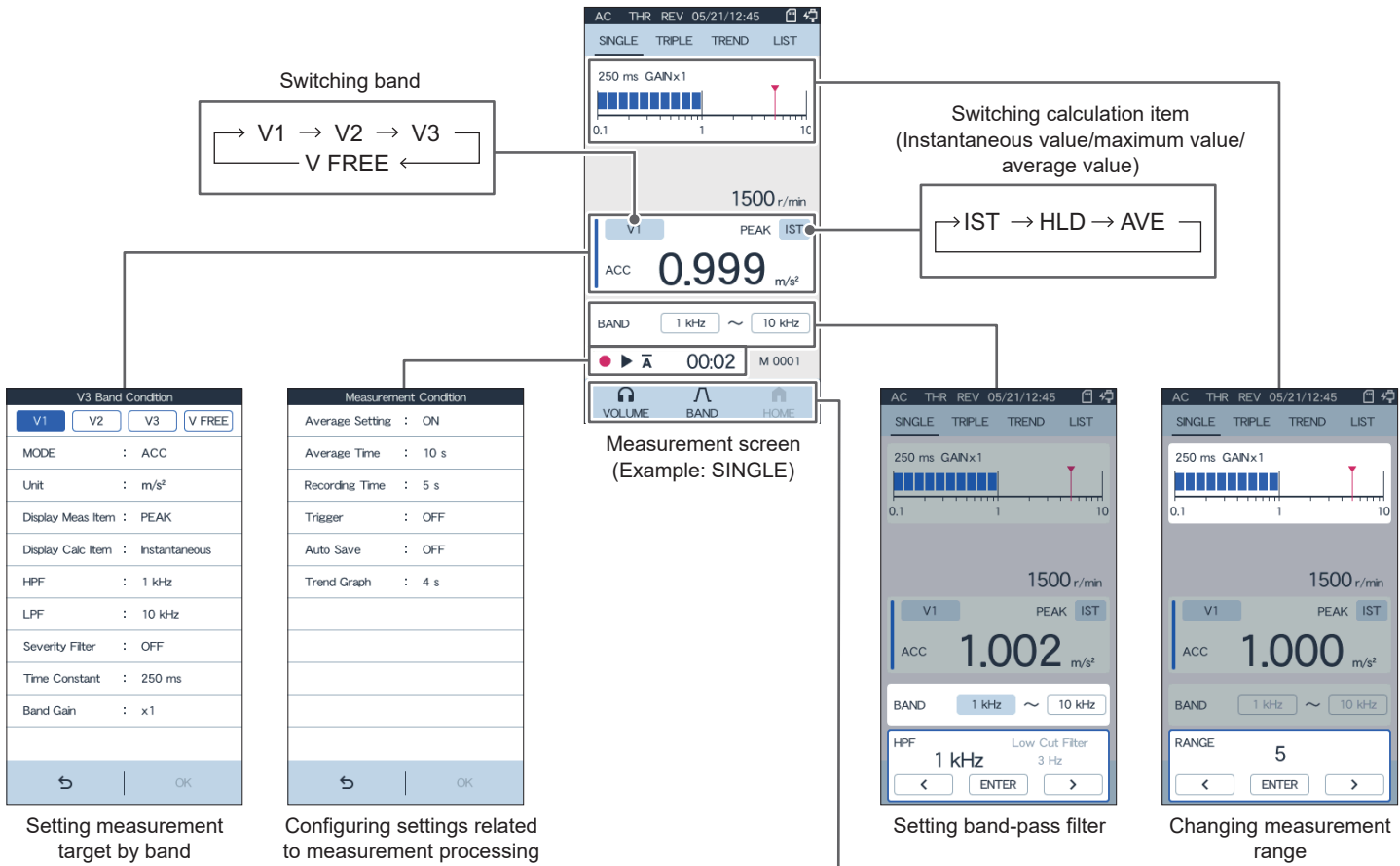

Operation buttons

VOLUME	Used to adjust volume or enable/disable muting.
BAND	Used to apply/cancel the band-pass filter (BPF) processing on the sound output from the PHONE connector. This operation is performed for the PHONE output, and thus a measured value is not affected.
HOME	Used to display the [HOME] screen. The button turns gray during measurement and enters an inoperable state.